



## COVID-19 Lateral Flow Testing Program – Ralph Thoresby School

03 March 2021

Dear parent/guardian,

I am writing to you to share further details about the Lateral Flow Testing Program at Ralph Thoresby School.

### Government guidance and consent

Schools have been asked to offer 3 Lateral Flow Tests to all students and staff. Details about these tests are available at <https://www.gov.uk/guidance/understanding-lateral-flow-antigen-testing-for-people-without-symptoms>. Offering these tests to the whole school community will give us the best chance of creating an environment that is as free of the virus as possible. We have already requested parental consent for the tests and, if you haven't already responded, this can be via the parent portal on the website. If you require assistance please email [avril.lewis@ralphthoresby.com](mailto:avril.lewis@ralphthoresby.com).

### Where?

The school sports hall has been set up, in-line with government guidance, as our testing centre. In order to keep the centre as separate from the main school as possible we are asking students, who are to be tested, to arrive from the **Farrar Lane Gate** entrance only. All students who attend testing are asked to wear their school uniform. No adults are allowed to accompany a student on the school site, we understand that some parents may wish to drop off and pick up their child, please can these parents wait in the sports centre car park.

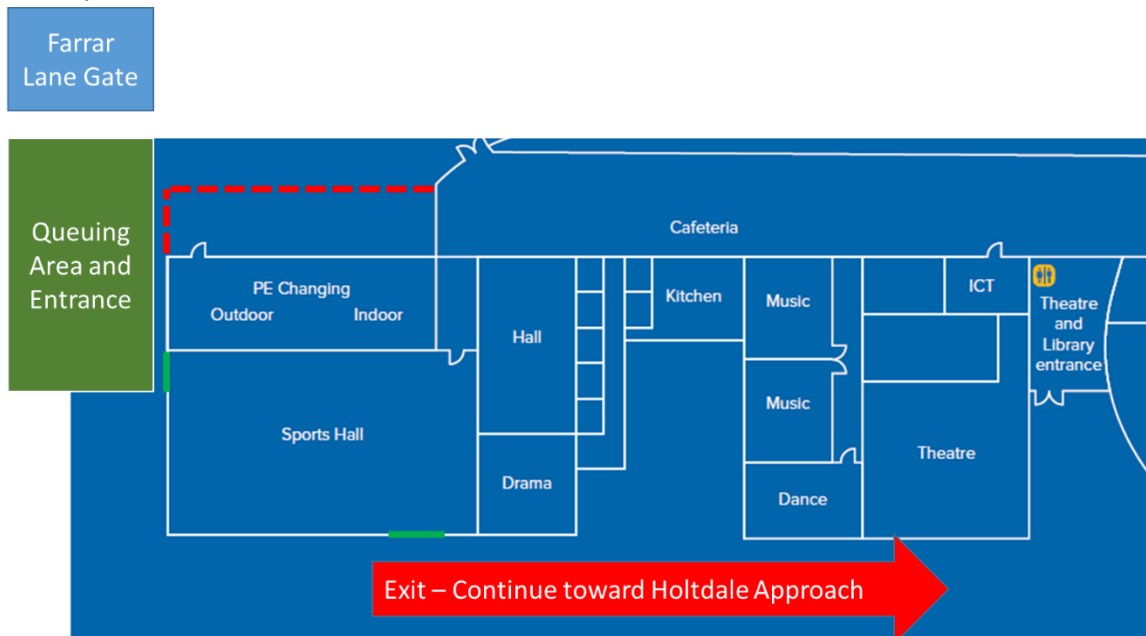



### How?

A queueing area has been marked out to ensure 2 metre social distancing is observed and staff will be present to support the students. Students will be invited to enter the sports hall where they will be registered before being directed to a swabbing station. At the station students will be given guidance for self-swabbing, they will then complete the swab and leave the sports hall through the exit. Face coverings must be worn when queueing and whilst in the testing centre. Upon completion of the swab students will be asked to leave the sports hall and return home, staff will be present to ensure this runs smoothly.

### When?

It is vital that students arrive at their designated time shown below on Wednesday 10<sup>th</sup>, Monday 15<sup>th</sup> and Thursday 18<sup>th</sup> March. The test should take no longer than 5 minutes.

09:00	8DSI (28)
09:20	8ELI (22)
09:40	8FM (23)
10:00	8HOX (20)
10:20	8ET (29)
10:40	8CGA (27)
11:00	8AJY (24)

### Results

The school will keep a record of the results and contact parents immediately should a positive test be recorded for your child. All students and tests will be registered with gov.uk and you will receive confirmation of the test result to the contact details you have supplied. This confirmation will be toward the end of the day when we bulk upload the schools results.

I would like to take this opportunity to remind you that if a student has symptoms they should not attend school, a PCR test should be booked and the results of this test shared with the school. Students will also not be tested in school if they have had a positive PCR test within the last 90 days as this can show up as a false positive on the lateral flow test.

We have produced a useful [video](#) about returning to school and the onsite testing.

Yours sincerely,

Graham Cowgill  
Assistant Headteacher

Email: [gcowgill@ralphthoresby.com](mailto:gcowgill@ralphthoresby.com)

Phone: 01133979905

